

AIR-BLOC® 16MR
 25 mm OVERLAP WHERE AIR-BLOC® 16MR LAPS ONTO SELF-ADHERED MEMBRANE

BLUESKIN® BUTYL FLASH, BLUESKIN® SA, BLUESKIN® SALT, OR FOILSKIN® (INSTALL SELF-ADHERED MEMBRANES IN A TARGET PATTERN)

POLYBITUME® 570-05, 925 BES SEALANT, OR AIR-BLOC® LF

BLUESKIN® BUTYL FLASH, BLUESKIN® SA, BLUESKIN® SALT, OR FOILSKIN® (INSTALL SELF-ADHERED MEMBRANES IN A FINGER PATTERN)

ALTERNATE LAP METHOD

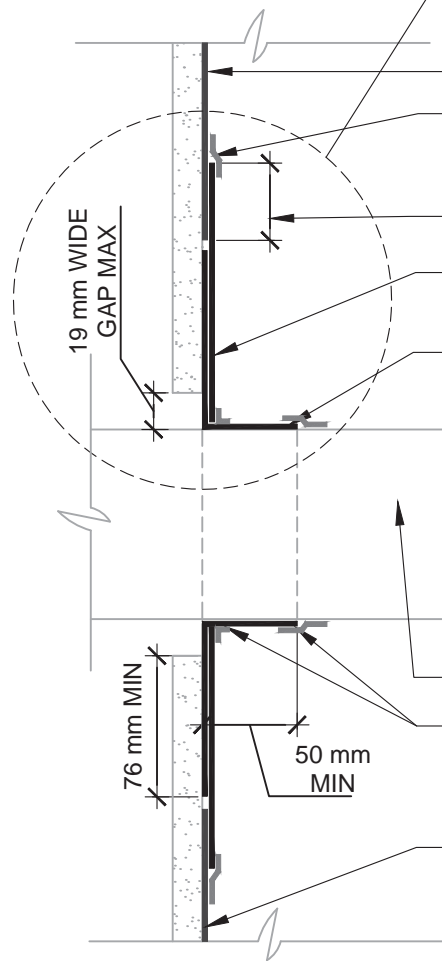

AIR-BLOC® 16MR

POLYBITUME® 570-05, 925 BES SEALANT, OR AIR-BLOC® LF (TROWEL UNTIL MEMBRANE EDGE IS FULLY COATED TO PROMOTE WATER SHEDDING)

50 mm MIN OVERLAP WHERE FLASHING LAPS ONTO AIR-BLOC® 16MR

BLUESKIN® BUTYL FLASH, BLUESKIN® SA, BLUESKIN® SALT, OR FOILSKIN® (INSTALL SELF-ADHERED MEMBRANES IN A TARGET PATTERN)

BLUESKIN® BUTYL FLASH, BLUESKIN® SA, BLUESKIN® SALT, OR FOILSKIN® (INSTALL SELF-ADHERED MEMBRANES IN A FINGER PATTERN)

SECURED PIPE

POLYBITUME® 570-05, 925 BES SEALANT, OR AIR-BLOC® LF (TROWEL UNTIL MEMBRANE EDGE IS FULLY COATED TO PROMOTE WATER SHEDDING)

AIR-BLOC® 16MR

NOTES:

1. DETAIL SHOWS AIR-BLOC® 16MR ASSEMBLY INSTALLED OVER EXTERIOR GRADE GYPSUM SHEATHING. OTHER ACCEPTABLE SUBSTRATES INCLUDE PLYWOOD, OSB, CONCRETE, AND CONCRETE BLOCK.
2. INSULATION AND CLADDING NOT SHOWN FOR CLARITY.
3. WHERE REQUIRED PRIME SUBSTRATE PRIOR TO SELF-ADHERED FLASHING INSTALLATION. REFER TO PRODUCT SPECIFIC TECHNICAL DATA SHEET (TDS) FOR PRIMER PRODUCT AND APPLICATION RATE RECOMMENDATIONS.
4. REFER TO AIR-BLOC® 16MR GUIDE SPECIFICATION FOR RECOMMENDED INSTALLATION PROCEDURES.

MANUFACTURER GUIDE DETAILS ARE FOR REFERENCE ONLY. HENRY® DOES NOT ASSUME RESPONSIBILITY FOR ERRORS OR DEVIATIONS IN DESIGN OR ENGINEERING. PROJECT SPECIFIC VERIFICATION IS RECOMMENDED PRIOR TO INSTALLATION.

AIR-BLOC® 16MR AIR AND VAPOUR BARRIER

PIPE PENETRATION
 SUBSTRATE GAPS UP TO 19 mm WIDE GAP MAXIMUM
 SELF-ADHERED FLASHING

SCALE: N.T.S. 10-25-2016

AB16MR - 2B



15 Wallsend Drive,
 Scarborough, Ontario, M1E 3X6
 800-486-1278 • www.henry.com