

AIR-BLOC® 16MR

25 mm OVERLAP WHERE **AIR-BLOC® 16MR** LAPS ONTO FLASHING

METAL HEAD FLASHING (TYPICAL)

BLUESKIN® BUTYL FLASH, BLUESKIN® SA, BLUESKIN® SALT, FOILSKIN®, OR AIR-BLOC® LF

25 mm OVERLAP WHERE **AIR-BLOC® 16MR** LAPS ONTO FLASHING

AIR-BLOC® 16MR

BLUESKIN® BUTYL FLASH, BLUESKIN® SA, BLUESKIN® SALT, FOILSKIN®, OR AIR-BLOC® LF

EXTEND FLASHING 76 mm RECOMMENDED (50 mm MIN) INTO ROUGH OPENING

AIR-BLOC® 16MR

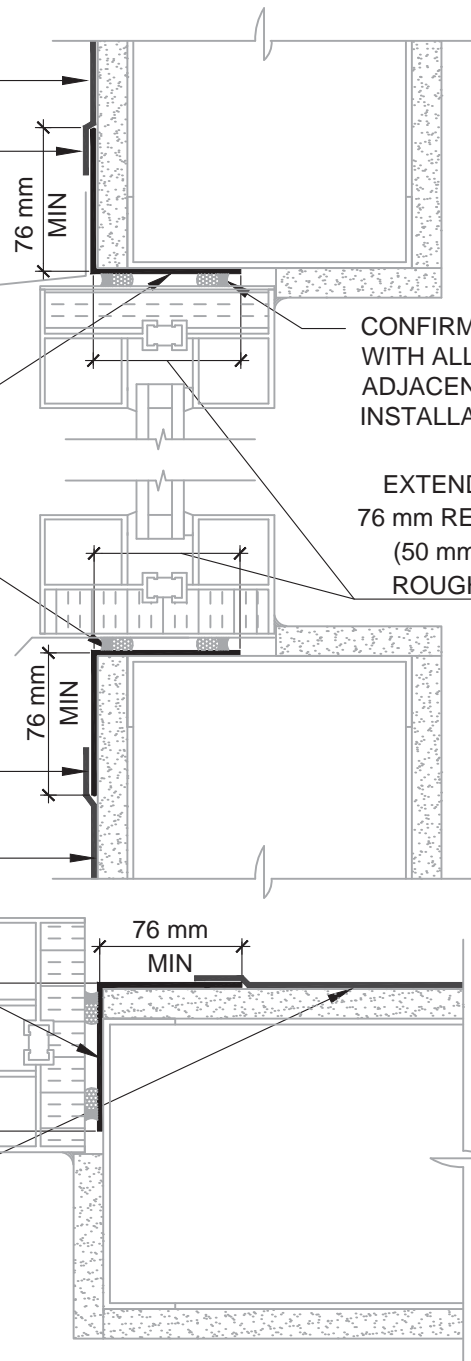

HEAD

CONFIRM SEALANT COMPATIBILITY WITH ALL SUBSTRATES AND ADJACENT PRODUCTS PRIOR TO INSTALLATION

EXTEND FLASHING 76 mm RECOMMENDED (50 mm MIN) INTO ROUGH OPENING

SILL

JAMB

NOTES:

1. DETAIL SHOWS **AIR-BLOC® 16MR** ASSEMBLY INSTALLED OVER EXTERIOR GRADE GYPSUM SHEATHING. OTHER ACCEPTABLE SUBSTRATES INCLUDE PLYWOOD, OSB, CONCRETE, AND CONCRETE BLOCK.
2. INSULATION AND CLADDING NOT SHOWN FOR CLARITY.
3. INSTALL FLASHING AT SILL PAN EXTENDING 152 mm MINIMUM UP JAMB.
4. WINDOW INSTALLATION REQUIREMENTS TO BE VERIFIED BY DESIGN PROFESSIONAL.
5. REFER TO **AIR-BLOC® 16MR** GUIDE SPECIFICATION FOR RECOMMENDED INSTALLATION PROCEDURES.

Henry®

15 Wallsend Drive,
Scarborough, Ontario, M1E 3X6
800-486-1278 • www.henry.com

MANUFACTURER GUIDE DETAILS ARE FOR REFERENCE ONLY. HENRY® DOES NOT ASSUME RESPONSIBILITY FOR ERRORS OR DEVIATIONS IN DESIGN OR ENGINEERING. PROJECT SPECIFIC VERIFICATION IS RECOMMENDED PRIOR TO INSTALLATION.

AIR-BLOC® 16MR AIR AND VAPOUR BARRIER

REBATE WINDOW

METHOD A - **AIR-BLOC® 16MR** INSTALLED AFTER SELF-ADHERED OR LIQUID APPLIED FLASHING

SCALE: N.T.S.

10-25-2016

AB16MR - 6A1