

Create bellows in membrane by looping into gap. Prior to installation, adhere membrane to itself and install to prevent adhesion to surfaces within gap.

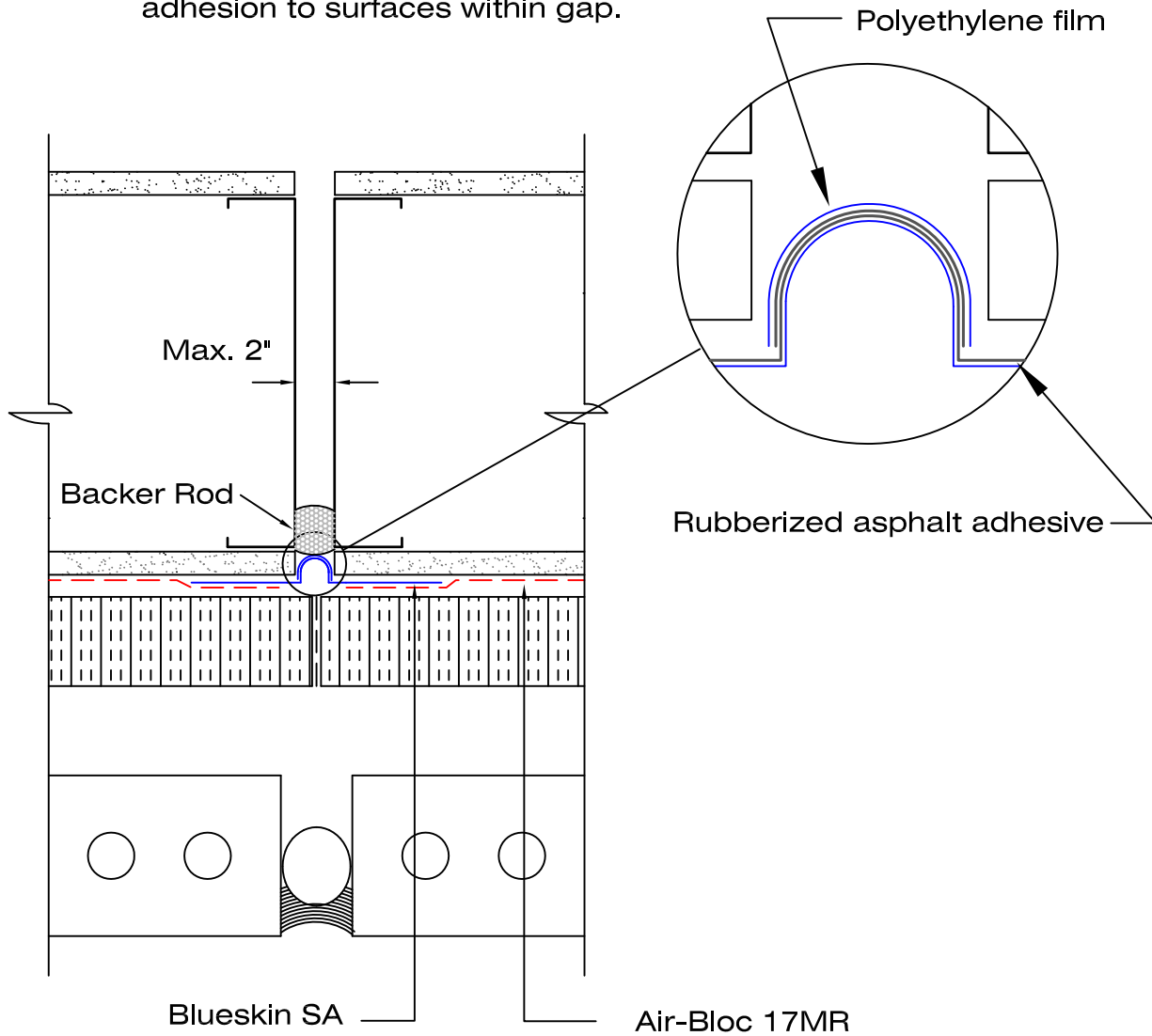

Notes:

1. At expansion joints, loop Blueskin SA membrane sufficiently into the opening to allow for movement and lap over both sides.
2. Blueskin SA membrane must not be adhered to surfaces within expansion joint.
3. Blueskin SA membrane is not deigned or intended for expansion joints where seismic or shear movement is anticipated.
4. A seal on interior wall side of expansion joint is required to mitigate positive pressure from within building.

Henry
COMPANY

VAPOR PERMEABLE AIR-BLOC AIR BARRIER

SCALE: N.T.S.

BRICK VENEER/ METAL STUD WALL

10-07-14

**EXPANSION JOINT
DETAIL**

LPS-05