

**BLUESKIN® VP160** FLANGED WINDOW DETAIL GUIDELINES CONSIST OF THREE PARTS. REFER TO DETAILS BSVP160 - 6C1 AND BSVP160 - 6C2 FOR PREVIOUS STEPS 1-4.

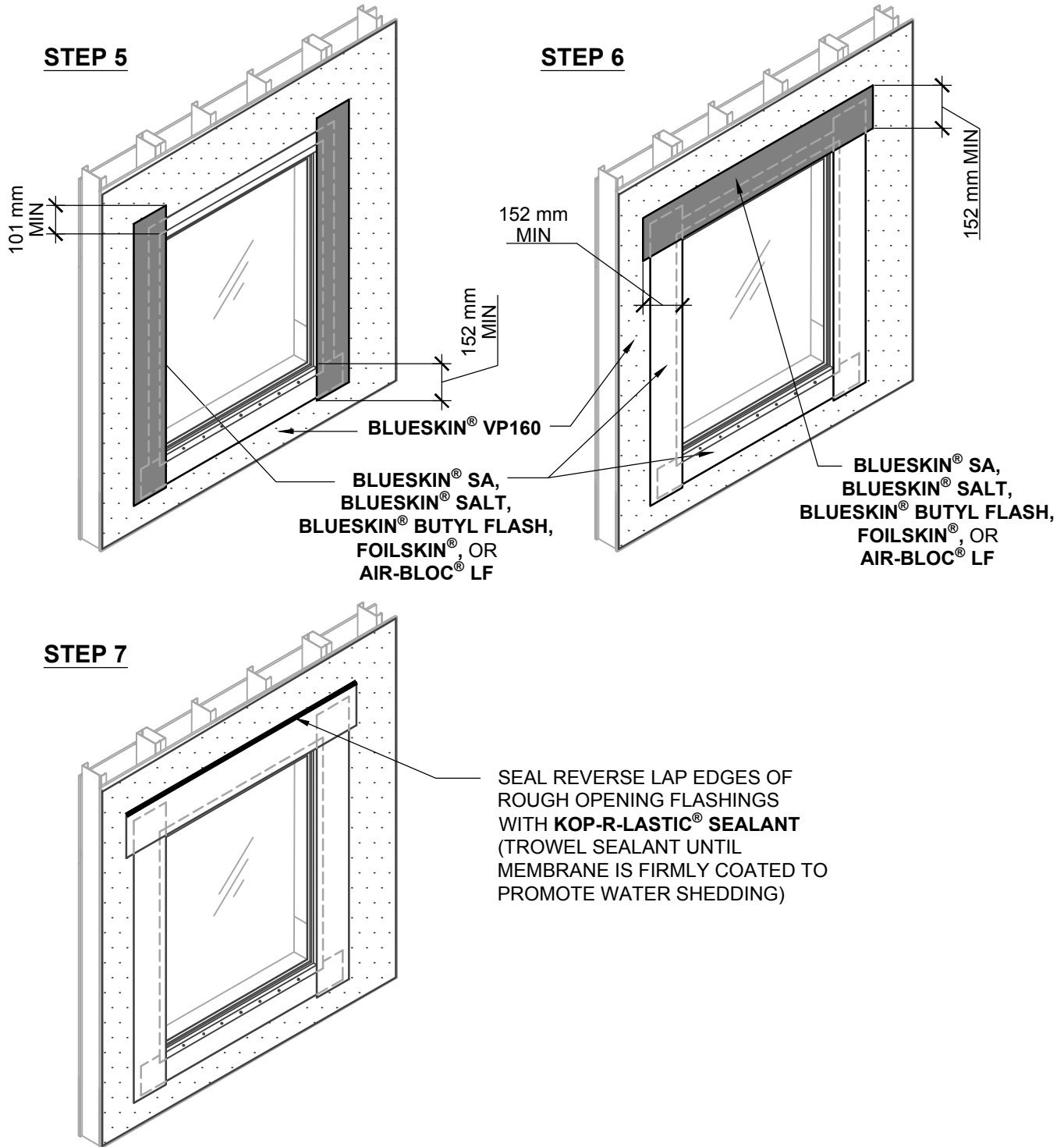

**NOTES:**

1. REFER TO NOTES BSVP160 - 6C1.

**Henry®**

15 Wallsend Drive,  
Scarborough, Ontario, M1E 3X6  
800-486-1278 • www.henry.com

MANUFACTURER GUIDE DETAILS ARE FOR REFERENCE ONLY. HENRY® DOES NOT ASSUME RESPONSIBILITY FOR ERRORS OR DEVIATIONS IN DESIGN OR ENGINEERING. PROJECT SPECIFIC VERIFICATION IS RECOMMENDED PRIOR TO INSTALLATION.

**BLUESKIN® VP160 SELF-ADHERED WATER RESISTIVE AIR BARRIER**

**FLANGED WINDOW**

SELF-ADHERED OR LIQUID APPLIED FLASHING  
PART 3 OF 3

SCALE: N.T.S.

09-29-2016

**BSVP160 - 6C3**