

1. Deck
2. Adhesive
3. Flashing Sheet
4. 790-11 Membrane
5. Polyester Fabric Reinforcement
6. 790-11 Membrane
7. Separation Layer
8. Extruded Polystyrene Insulation
9. Filter Fabric
10. Pavers or Stone Ballast
11. Metal Flashing

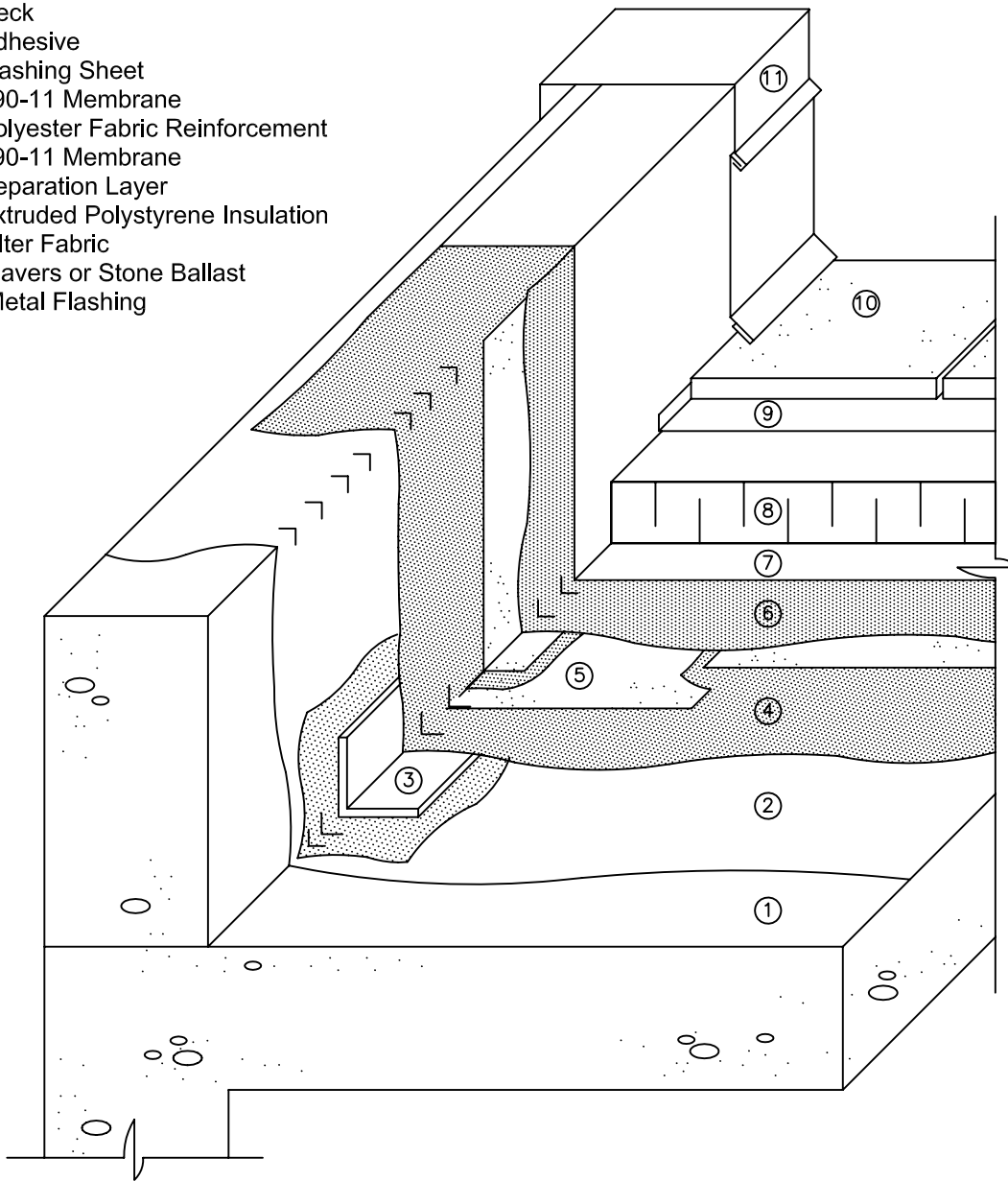

Notes

1. System detail flashing membrane may be modifiedPLUS modified bitumen sheet or 990-25 flashing sheet.
2. The Polyester Fabric Reinforcement overlaps approximately 6mm (1/4"). A coat of 790-11 must be applied at the laps as shown.
3. There are two types of primers for 790-11: 910-01 an asphalt penetrating primer and Poly-Tac™ a polymer modified primer. Superior membrane to deck adhesion is provided when Poly-Tac™ primer is used.
4. Use either an asphaltic core hardboard or modifiedPLUS modified bitumen sheet for the separation layer.

790-11 Membrane P.M.R. Assembly

SYSTEM DETAIL 1

CONCRETE DECK

Scale: N.T.S.

Plot: 1:10

Issued: 05-14-97

Revision: 05

HR-1E97



15 Walsend Drive, Toronto ON M1E 3X6
 Technical Services - 800-486-1278
 Email: techservices@henry.com
 www.ca.henry.com