

1. Deck
2. Adhesive
3. modifiedPLUS® NP180gT4
4. 790-11 Membrane
5. Polyester Fabric Reinforcement
6. 790-11 Membrane
7. Separation Layer
8. Extruded Polystyrene Insulation
9. Filter Fabric
10. Pavers
11. Metal Flashing

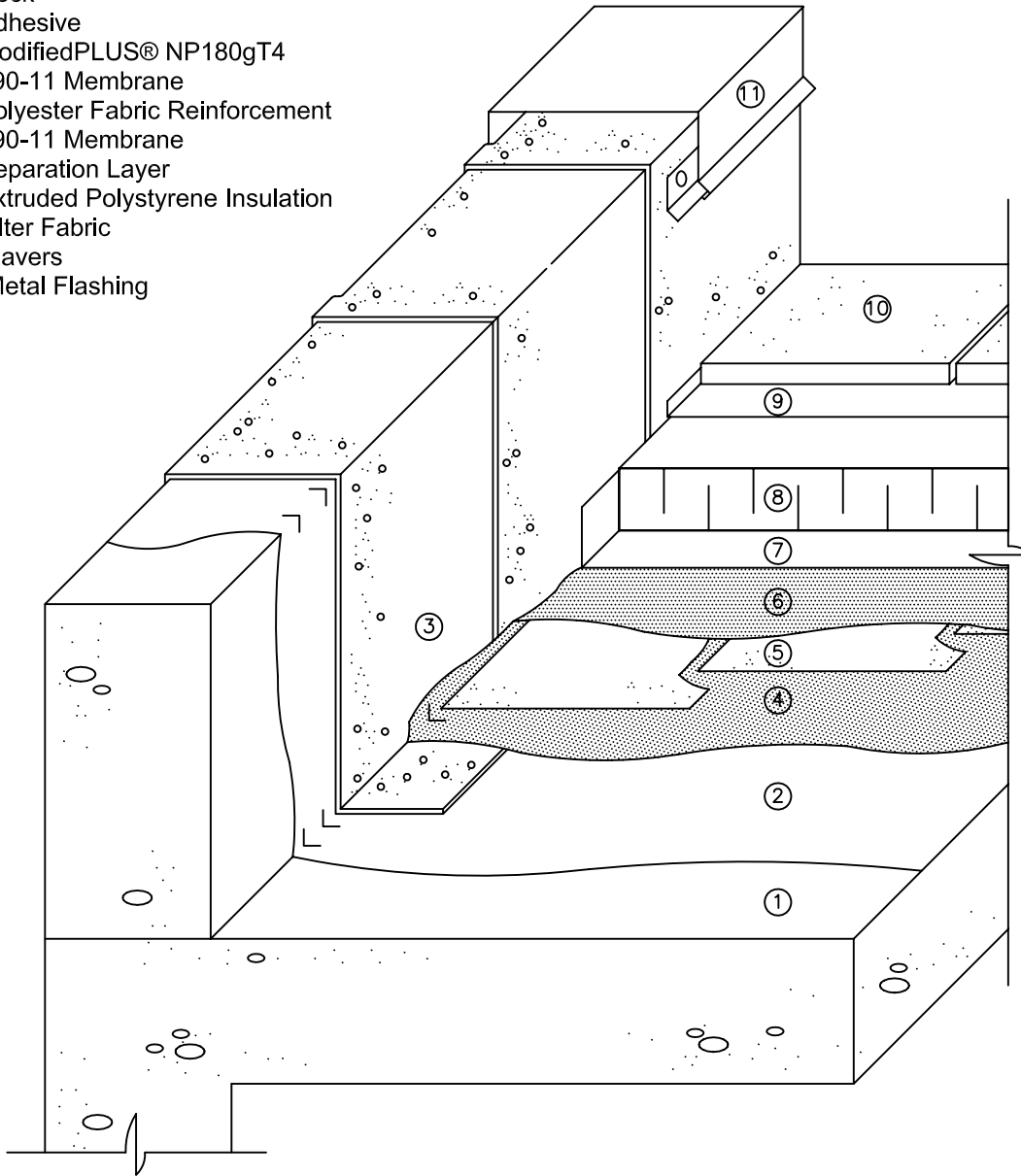

### Notes

1. System detail showing modifiedPLUS® NP180gT4 SBS modified bitumen sheet as the flashing membrane. The NP180gT4 sheet is thermofused to the substrate prior to application of the 790-11 hot applied rubberized asphalt.
2. Drainage layers are optional on all 790-11 details and should be positioned above the insulation layer.
3. The modifiedPLUS® NP180gT4 sheet has a ceramic granule surface which is designed to be an exposed finished surface.

790-11 Membrane P.M.R. Assembly

Scale: N.T.S.

Plot: 1:10

Issued: 05-14-97

Revision: 05

## SYSTEM DETAIL 3

CONCRETE DECK

# HR-3E97



15 Wallsend Drive, Toronto ON M1E 3X6  
 Technical Services - 800-486-1278  
 Email: techservices@henry.com  
 www.ca.henry.com