

EDGE DETAIL NOT APPLICABLE FOR ALL BUILDING TYPES AND/OR REGIONS. EDGE DETAIL AND BALLAST MAY REQUIRE A PARAPET AND/OR PAVER STRAPS TO MEET MINIMUM WIND UPLIFT REQUIREMENTS. REFER TO DESIGN PROFESSIONAL TO CONFIRM WIND UPLIFT AND ROOF EDGE REQUIREMENTS.

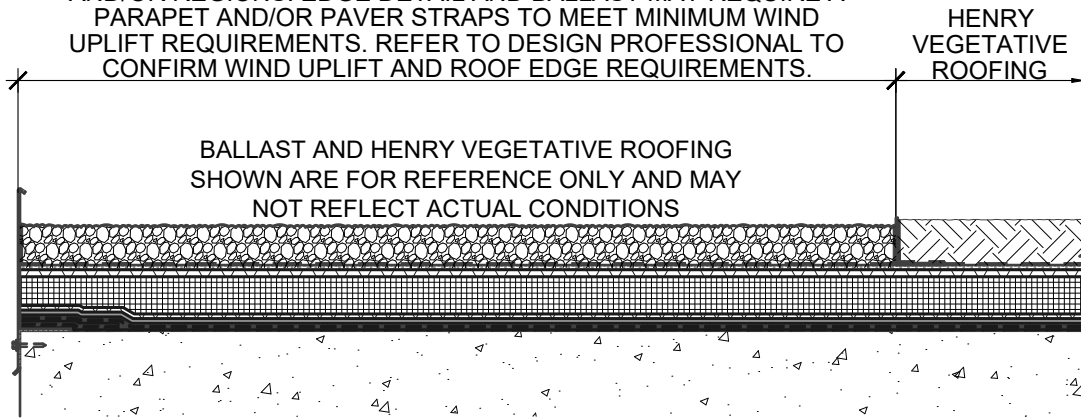

BALLAST AND HENRY VEGETATIVE ROOFING SHOWN ARE FOR REFERENCE ONLY AND MAY NOT REFLECT ACTUAL CONDITIONS

HENRY VEGETATIVE ROOFING

VEGETATIVE FREE ZONE EXAMPLE AT ROOF EDGE

N.T.S

VARIES (SEE NOTE #4)

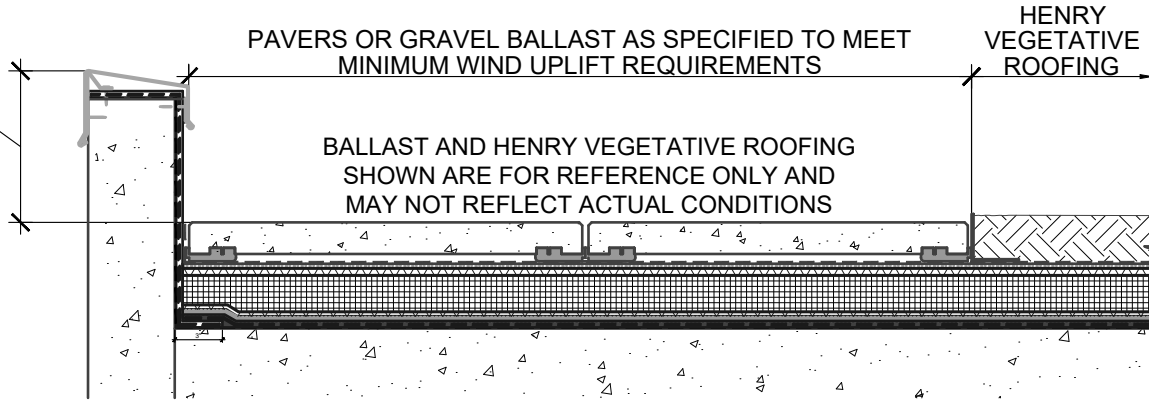

PAVERS OR GRAVEL BALLAST AS SPECIFIED TO MEET MINIMUM WIND UPLIFT REQUIREMENTS

BALLAST AND HENRY VEGETATIVE ROOFING SHOWN ARE FOR REFERENCE ONLY AND MAY NOT REFLECT ACTUAL CONDITIONS

HENRY VEGETATIVE ROOFING

VEGETATIVE FREE ZONE EXAMPLE AT PARAPET

N.T.S

NOTES:

1. DETAIL SHOWS HENRY VEGETATIVE ROOFING WITH **PUMADEQ** SYSTEM WATERPROOFING ASSEMBLY WITH A REINFORCED FIELD MEMBRANE. SUBSTRATE SHOWN IS FOR REFERENCE ONLY. REFER TO PRODUCT SPECIFIC TECHNICAL DATA SHEET FOR AUTHORIZED SUBSTRATES.
2. EDGE DETAIL NOT APPLICABLE FOR ALL BUILDING TYPES OR REGIONS. BUILDNG MAY REQUIRE PARAPET AND/OR PAVER STRAPS TO MEET MINIMUM WIND UPLIFT REQUIREMENTS.
3. DO NOT INSTALL **PUMADEQ** SYSTEM BEYOND PRIMED SURFACES.
4. BACK COAT FLEECE ON VERTICAL SURFACES WITH **PUMADEQ** RESIN.
5. DEPTH OF GROWING MEDIA MAY VARY DEPENDING ON PROJECT SPECIFIC REQUIREMENTS.
6. DETAIL IS FOR REFERENCE ONLY. REFER TO DESIGN PROFESSIONAL TO VERIFY WIND UPLIFT REQUIREMENTS.
7. REFER TO THE **PUMADEQ** SYSTEM GUIDE SPECIFICATION AND WATERPROOFING DETAILS FOR RECOMMENDED INSTALLATION PROCEDURES.



999 N. Pacific Coast Hwy, Suite 800
El Segundo, CA 90245
800-486-1278 • www.henry.com

MANUFACTURER GUIDE DETAILS ARE FOR REFERENCE ONLY. HENRY DOES NOT ASSUME RESPONSIBILITY FOR ERRORS OR DEVIATIONS IN DESIGN OR ENGINEERING. PROJECT SPECIFIC VERIFICATION IS RECOMMENDED PRIOR TO INSTALLATION.

VEGETATIVE ROOFING - PUMADEQ SYSTEM

VEGETATIVE FREE ZONE

EXAMPLE OF POSSIBLE PARAPET /ROOF EDGE CONDITIONS AT A VEGETATIVE ROOFING

SCALE: N.T.S.

06-01-2020

VR-PUMA-R3